



# MUSTANGS

Testing Curriculum  
Chat

This presentation covers:

- 1) How to read your child's FSA score report
- 2) district initiatives to monitor student progress (iReady and CFQ/CSA)



## How to access your child's FSA scores

- 1) Go to Mill Creek's main webpage: <https://www-mca.stjohns.k12.fl.us/>
- 2) Log into HAC (this is also how you access your child's grades).

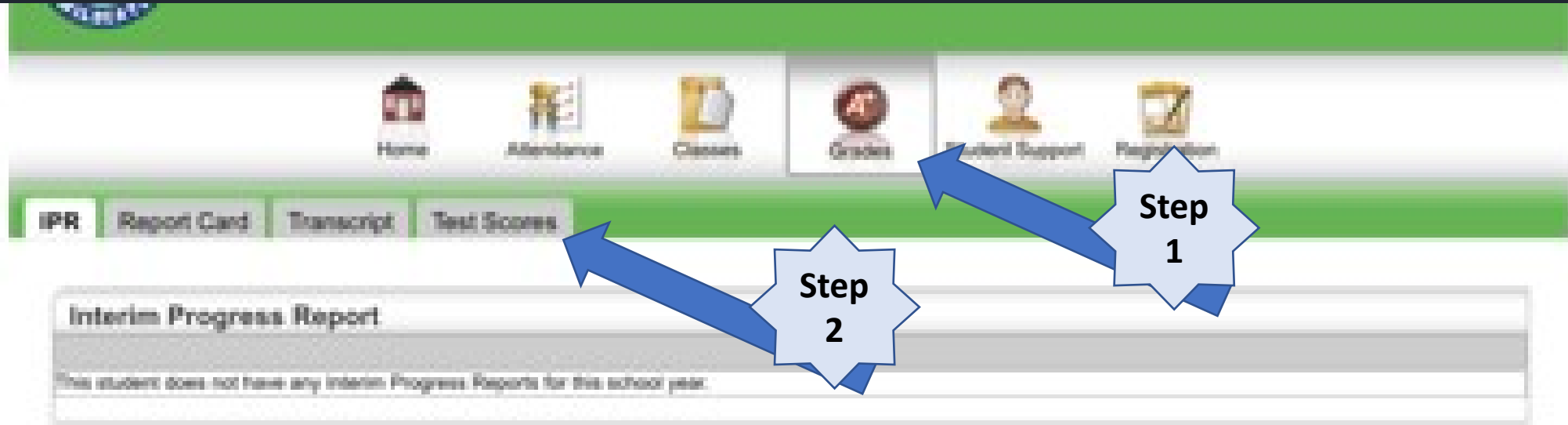

## Once in HAC...

- 1) Click on grades
- 2) Then click on test scores

# How to read your child's FSA Score Report: ELA

FSA ELA Reading	Achievement Level: 5 Raw Score: 50	Scale Score: 353
FSA Mathematics	Achievement Level: 4 Raw Score: 37	Scale Score: 336
Knowledge and Ideas	Raw Score: 12	Points Possible: 12
Language/Editing Task	Raw Score: 7	Points Possible: 7
Craft and Structure	Raw Score: 11	Points Possible: 11
Key Ideas and Details	Raw Score: 12	Points Possible: 12
Text-Based Writing	Raw Score: 8	Points Possible: 8
Purpose, Focus, and Org	Raw Score: 3	Points Possible: 3
Evidence and Elaboration	Raw Score: 3	Points Possible: 3
Conventions	Raw Score: 2	Points Possible: 2
Nbrs/Oper in Base Ten	Raw Score: 12	Points Possible: 12
Oper/Algebraic Thinking/Fract	Raw Score: 12	Points Possible: 12
Measurement/Data/Geometry	Raw Score: 13	Points Possible: 13

- The left column tells which test. The right column gives the achievement level and scale score. This sample shows the student earned a level 5 in ELA with a scale score of 353.
- Underneath the sub scores are listed. For ELA, there are 4 sub scores: knowledge and ideas, language/editing, craft and structure and key ideas and details. Raw scores are given and should be compared to the possible points. This will tell you which area your child struggled with or did the best on.
- Beginning in grade 4, students also take FSA writing. The score can be found as a sub score underneath FSA ELA
- Writing scores are broken down into: Purpose/focus/organization, evidence/elaboration and conventions

# How to read your child's FSA Score Report: Math

<b>FSA ELA Reading</b>	<b>Achievement Level: 5</b>	<b>Scale Score: 353</b>
	<b>Raw Score: 50</b>	
<b>FSA Mathematics</b>	<b>Achievement Level: 4</b>	<b>Scale Score: 336</b>
	<b>Raw Score: 37</b>	
<b>Knowledge and Ideas</b>	<b>Raw Score: 12</b>	<b>Points Possible:</b>
<b>Language/Editing Task</b>	<b>Raw Score: 7</b>	<b>Points Possible:</b>
<b>Craft and Structure</b>	<b>Raw Score: 11</b>	<b>Points Possible:</b>
<b>Key Ideas and Details</b>	<b>Raw Score: 12</b>	<b>Points Possible:</b>
<b>Text-Based Writing</b>	<b>Raw Score: 8</b>	<b>Points Possible:</b>
<b>Purpose, Focus, and Org</b>	<b>Raw Score: 3</b>	<b>Points Possible:</b>
<b>Evidence and Elaboration</b>	<b>Raw Score: 3</b>	<b>Points Possible:</b>
<b>Conventions</b>	<b>Raw Score: 2</b>	<b>Points Possible:</b>
<b>Nbrs/Oper in Base Ten</b>	<b>Raw Score: 12</b>	<b>Points Possible:</b>
<b>Oper/Algebraic Thinking/Fract</b>	<b>Raw Score: 12</b>	<b>Points Possible:</b>
<b>Measurement/Data/Geometry</b>	<b>Raw Score: 13</b>	<b>Points Possible:</b>



- The left column tells which test. The right column gives the achievement level and scale score. This sample shows the student earned a level 4 in Math with a scale score of 336.
- Underneath the sub scores are listed. For math, there are 3 sub scores: Numbers and operations, algebraic thinking/fractions and measurement/data/geometry. Raw scores are given and should be compared to the possible points. This will tell you which area your child struggled with or did the best on.



# What do FSA Scores mean?

**Table 1. Achievement Levels**

Level 1	Level 2	Level 3	Level 4	Level 5
Inadequate: Highly likely to need substantial support for the next grade	Below Satisfactory: Likely to need substantial support for the next grade	Satisfactory: May need additional support for the next grade	Proficient: Likely to excel in the next grade	Mastery: Highly likely to excel in the next grade

- Achievement levels are used to describe the extent to which a student mastered grade level content.
- The FL Department of Education gives the descriptions above to explain how scores can be interpreted and what they mean for students in the following grade. Thinking back to our previous score report, our sample student earned a Level 5 in ELA, which means “Mastery: Highly likely to excel in the next grade”. This means the sample student fully mastered all previous content and is very likely to be successful in the upcoming year.

# Interpreting Scale Scores

- Each year, the FL DOE releases scale scores for achievement levels. These change yearly based on student averages.
- To find your child's scale score performance, first locate the grade they took the assessment in.
- For our sample, our student took the grade 5 math and earned a scale score of 336, which placed them at a level 4. According to this breakdown, this score was in the lower range of a level 4, which ranged from 334-349. This means the student was borderline of earning a level 3.

Table 2. Grade-Level Assessment Scale Scores for Each Achievement Level

Assessment		Level 1	Level 2	Level 3	Level 4	Level 5
FSA English Language Arts Scale Scores (240–412) for Each Achievement Level	Grade 3	240–284	285–299	<b>300–314</b>	315–329	330–360
	Grade 4	251–296	297–310	<b>311–324</b>	325–339	340–372
	Grade 5	257–303	304–320	<b>321–335</b>	336–351	352–385
	Grade 6	259–308	309–325	<b>326–338</b>	339–355	356–391
	Grade 7	267–317	318–332	<b>333–345</b>	346–359	360–397
	Grade 8	274–321	322–336	<b>337–351</b>	352–365	366–403
	Grade 9	276–327	328–342	<b>343–354</b>	355–369	370–407
FSA Mathematics Scale Scores (240–393) for Each Achievement Level	Grade 3	240–284	285–296	<b>297–310</b>	311–326	327–360
	Grade 4	251–298	299–309	<b>310–324</b>	325–339	340–376
	Grade 5	256–305	306–319	<b>320–333</b>	334–349	350–388
	Grade 6	260–309	310–324	<b>325–338</b>	339–355	356–390
	Grade 7	269–315	316–329	<b>330–345</b>	346–359	360–391
	Grade 8	273–321	322–336	<b>337–352</b>	353–364	365–393
NGSSS Science Scale Scores (140–260) for Each Achievement Level	Grade 5	140–184	185–199	<b>200–214</b>	215–224	225–260
	Grade 8	140–184	185–202	<b>203–214</b>	215–224	225–260

# How do schools use this information?

- Your child's teachers and school use this information to know how to best help your child learn. We break down your child's scores and target their strengths to extend their knowledge and their weaknesses to remediate and reteach.
- **SJCSD also utilizes several progress monitoring tools to help teachers track your child's progress throughout the year. These include: iReady diagnostic and CFQs/CSAs.**





# What is i-Ready?

- It is a computer-based adaptive assessment tool for Reading and Math.
- The diagnostic assessments will be used with students in grades K – 8.
- It will provide data that should be used to inform instruction.
- i-Ready provides teachers with the same category breakdowns so they can see how your child is progressing in each area of ELA and Math.
- i-Ready is done three times a year for progress monitoring: fall, winter and spring

# CFQ/CSA Quick Facts

- CFQ= Common Focus Quiz; used in grades 3-5; **UNGRADED FORMATIVE**
- CSA = Common Summative Assessment; used in grades 6-12; **GRADED SUMMATIVE**
- Created and provided by SJC Curriculum Teams and are given on the following schedule:
  - I. Grades 3-5 ELA/Math (4/year)
  - II. Grade 5 Science (2/year)
  - III. Grade 6 Std Math (3/year)
  - IV. Grade 7 Civics (3/year)
  - V. Grade 8 Std Science (3/year)
  - VI. Std Algebra and Geometry (3/year)

- ❑ CFQs/CSAs are built into the curriculum pacing guide and align with essential standards taught from the quarter.
- ❑ They are short and should take less than 20 minutes for students to complete.
- ❑ Each question is designed to help teachers identify common mistakes their students are making.



# Next steps for families...

---

- Look over your child's FSA and iReady data in HAC
- Reach out to your child's teacher, or your school's testing coordinator with any questions
- Encourage your child to always try their best on any task (i-Ready, CFQ/CSA or classroom assessment)
- Remember we are all here to help your child succeed 😊

